

Jinbo Marine

Marine & Offshore Equipment Datasheet

PRODUCT DATASHEET

SHACKLE

BC Type JIS B2801 Bow Shackle

BC Type JIS B2801 Bow Shackle Technical Specification Nominal Size t d B B1 D ...

ISO9001 Supplier

Class Certificate

Export Supply

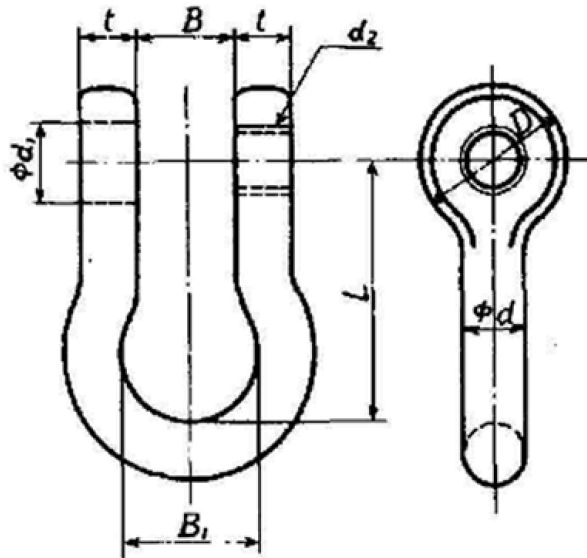

Key Highlights

Category	Shackle
Standard	JIS
Weight / Size	BC Type JIS B2801 Bow Shackle Technical Specification Nominal Size t d B...
Certificate	ABS, LR, BV, DNVGL, NK, KR, IRS, RMRS, CCS

We can supply according to your requirement, drawings, class certificate needs, and delivery schedule.

Technical Specifications			
Category	Shackle	Model / SKU	BC-Type-JIS-B2801-Bow-Shackle
Standard	JIS	Weight / Size	BC Type JIS B2801 Bow Shackle Technical Specification Nominal Size t d B B1 D d1 L Weight(kg) 6 8 11 20 17 9 36 0.07 8 8 10 14 25 21 11 45 0.15 10 10 12 17 30 25 13 54 0.31 12 12 14 20 35 32 16 63 0.48 14 14 16 24 40 36 18 72 0.67 16 16 18 26 45 40 20 80 0.93 18 18 21 29 53 45 22 95 1.35 20 20 23 31 58 50 25 104 2.15 22 22 26 34 65 55 27 117 2.98 24 24 28 39 70 62 31 126 3.77 26 26 30 41 75 66 33 135 4.45 28 28 32 43 80 70 35 144 5.36 30 30 34 45 85 75 37 153 6.1 32 32 37 48 93 80 39 167 7.56 34 34 39 50 98 85 41 176 9.05 36 36 42 54 105 90 43 190 10.32 38 38 44 57 110 95 47 198 11.7 40 40 47 60 118 100 49 212 13.13 Working Loat Limits
Certificate	ABS, LR, BV, DNVGL, NK, KR, IRS, RMRS, CCS	Warranty	12 Months unless specified otherwise
Origin	China		

CONTENTS	■ Technical Specification	■ Working Loat Limits
-----------------	---------------------------	-----------------------

Technical Specification

Nominal Size	t	d	B	B1	D	d1	L	Weight(kg)
6	6	8	11	20	17	9	36	0.07
8	8	10	14	25	21	11	45	0.15
10	10	12	17	30	25	13	54	0.31
12	12	14	20	35	32	16	63	0.48
14	14	16	24	40	36	18	72	0.67
16	16	18	26	45	40	20	80	0.93
18	18	21	29	53	45	22	95	1.35
20	20	23	31	58	50	25	104	2.15
22	22	26	34	65	55	27	117	2.98

24	24	28	39	70	62	31	126	3.77
26	26	30	41	75	66	33	135	4.45
28	28	32	43	80	70	35	144	5.36
30	30	34	45	85	75	37	153	6.1
32	32	37	48	93	80	39	167	7.56
34	34	39	50	98	85	41	176	9.05
36	36	42	54	105	90	43	190	10.32
38	38	44	57	110	95	47	198	11.7
40	40	47	60	118	100	49	212	13.13

Working Load Limits

Table 2. Working load limit

Nominal size	Grade												Unit : t	
	Grade M				Grade S				Grade T		Grade V		Bow shackle	Straight shackle
	Bow shackle		Straight shackle		Bow shackle		Straight shackle		Bow shackle		Straight shackle			
BA	BB	BC	BD	SA	SB	SC	SD	SB	SB	SB	SB	BB	SB	
6	—	—	0.2	0.15	—	—	0.2	—	—	—	—	—	—	—
8	—	—	0.315	0.315	—	—	0.315	—	—	—	—	—	—	—
10	—	—	(0.6)	0.5	—	—	(0.6)	0.4	0.8	0.8	1	1	1.25	1.25
12	—	—	1	(0.7)	—	—	1	0.63	1.6	1.6	2	2	2.5	2.5
14	—	—	1.25	(0.9)	—	—	1.25	0.8	2	2	2.5	2.5	3.15	3.15
16	—	—	1.6	(1.2)	—	—	1.6	1	2.5	2.5	3.15	3.15	4	4
18	—	—	2	(1.3)	—	—	2	—	3.15	3.15	4	4	5	5
20	—	—	2.5	2.5	1.8	—	2.5	2.5	1.6	4	4	5	5	6.3
22	—	—	3.15	3.15	—	—	3.15	3.15	2	5	5	6.3	6.3	—
24	—	—	(3.6)	(3.6)	—	—	(3.6)	(3.6)	2.5	6.3	6.3	—	8	8
26	—	—	4	4	—	—	4	4	3.15	—	—	—	8	8
28	—	—	(4.8)	(4.8)	—	—	(4.8)	(4.8)	(3.5)	8	8	10	10	10
30	—	—	5	5	—	—	5	5	—	8	10	10	12.5	12.5
32	—	—	6.3	6.3	—	—	6.3	6.3	—	10	12.5	12.5	16	16
34	(7)	(7)	(7)	(7)	(7)	(7)	(7)	5	—	12.5	12.5	16	16	—
36	8	8	8	—	8	8	8	—	12.5	12.5	16	16	20	20
38	(9)	(9)	(9)	—	(9)	(9)	(9)	6.3	—	—	—	—	—	—
40	10	10	10	—	10	10	(7)	16	16	20	20	25	25	—
42	(11)	(11)	—	—	(11)	(11)	—	8	—	—	—	—	—	—
44	12.5	12.5	—	—	12.5	12.5	—	20	20	25	25	31.5	31.5	—
46	(13)	(13)	—	—	(13)	(13)	—	—	—	—	—	—	—	—
48	14	—	—	—	14	14	—	10	—	—	—	—	—	—
50	16	16	—	—	16	16	—	25	25	31.5	31.5	40	40	—
52	—	—	—	—	—	—	—	12.5	—	—	—	—	—	—
55	18	18	—	—	18	18	—	—	—	—	—	—	—	—
58	—	—	—	—	—	—	—	16	—	—	—	—	—	—
60	20	20	—	—	20	20	—	31.5	31.5	40	40	50	50	—
65	25	25	—	—	25	25	—	40	40	50	50	63	63	—
70	31.5	31.5	—	—	31.5	31.5	—	50	50	63	63	80	80	—
75	(35)	(35)	—	—	(35)	(35)	—	—	—	—	—	—	—	—
80	40	40	—	—	40	40	—	63	63	80	80	100	100	—
85	45	45	—	—	45	45	—	—	—	—	—	—	—	—