

Jinbo Marine

Marine & Offshore Equipment Datasheet

PRODUCT DATASHEET

CHAIN SWIVEL

Chain Swivels G403

Main Specification Material: 45# Steel Finish: Spaying Painting , Spraying Plastics, Galvanized
Size Table Size (in) Working Load ...

ISO9001 Supplier

Class Certificate

Export Supply



Key Highlights

| | |
|---------------|--|
| Category | Chain Swivel |
| Standard | EN |
| Material | 45# Steel |
| Weight / Size | 45# Steel Finish: Spaying Painting , Spraying Plastics, Galvanized Size T... |
| Certificate | ABS, LR, BV, DNVGL, NK, KR, IRS, RMRS, CCS |

We can supply according to your requirement, drawings, class certificate needs, and delivery schedule.



| Technical Specifications | | | |
|--------------------------|--|-------------|--------------------------------------|
| Category | Chain Swivel | Model / SKU | Chain-Swivels-G403 |
| Standard | EN | Material | 45# Steel |
| Weight / Size | 45# Steel Finish:Spaying Painting , Spraying Plastics, Galvanized Size Table Size (in) Working Load Limit (lbs) Weight Each (lbs) Dimensions A B C G J K L M N P R T U V 1/4 850 0.25 1.25 0.69 0.75 0.69 0.69 0.47 1.03 0.31 0.88 0.25 2.63 3.38 1.69 1.69 5/16 1250 0.37 1.63 0.81 1 0.81 0.81 0.5 1.13 0.38 0.88 0.31 2.94 3.88 2.06 1.81 3/8 2250 0.7 2 0.94 1.25 1 1 0.63 1.41 0.5 1.06 0.38 3.63 4.75 2.5 2.25 1/2 3600 1.43 2.5 1.31 1.5 1.31 1.31 0.75 1.75 0.63 1.31 0.5 4.5 6.06 3.19 2.88 5/8 5200 2.48 3 1.56 1.75 1.63 1.5 0.94 2.06 0.75 1.5 0.63 5.31 7.31 3.88 3.44 3/4 7200 3.88 3.5 1.75 2 1.88 1.88 1.13 2.53 0.88 1.75 0.75 6.06 8.31 4.31 4 7/8 10000 5.75 4 2.06 2.25 2.13 2.13 1.19 2.75 1 2.06 0.88 7 9.53 5 4.53 | Surface | Galvanized |
| Certificate | ABS, LR, BV, DNVGL, NK, KR, IRS, RMRS, CCS | Warranty | 12 Months unless specified otherwise |
| Origin | China | | |

| | |
|-----------------|--|
| CONTENTS | <input checked="" type="checkbox"/> Main Specification <input type="checkbox"/> Size Table |
|-----------------|--|

Main Specification

Material: 45# Steel

Finish:Spaying Painting , Spraying Plastics, Galvanized

Size Table



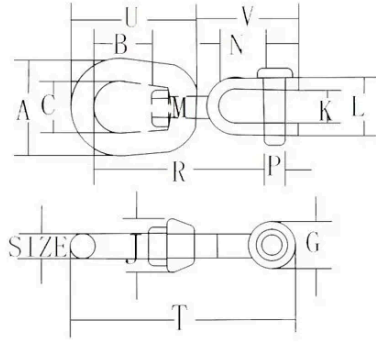

| Size (in) | Working Load Limit (1bs) | Weight Each (1bs) | Dimensions | | | | | | | | | | | | | |
|-----------|--------------------------|-------------------|------------|----------|----------|----------|----------|----------|----------|----------|----------|----------|----------|----------|----------|----------|
| | | | A | B | C | G | J | K | L | M | N | P | R | T | U | V |
| 1/4 | 850 | 0.25 | 1.2 5 | 0.6 9 | 0.7 5 | 0.6 9 | 0.6 9 | 0.4 7 | 1.0 3 | 0.3 1 | 0.8 8 | 0.2 5 | 2.6 3 | 3.3 8 | 1.6 9 | 1.6 9 |
| 5/16 | 1250 | 0.37 | 1.6 3 | 0.8 1 | 1 | 0.8 1 | 0.8 1 | 0.5 | 1.1 3 | 0.3 8 | 0.8 8 | 0.3 1 | 2.9 4 | 3.8 8 | 2.0 6 | 1.8 1 |
| 3/8 | 2250 | 0.7 | 2 | 0.9 4 | 1.2 5 | 1 | 1 | 0.6 3 | 1.4 1 | 0.5 | 1.0 6 | 0.3 8 | 3.6 3 | 4.7 5 | 2.5 | 2.2 5 |
| 1/2 | 3600 | 1.43 | 2.5 | 1.3 1 | 1.5 | 1.3 1 | 1.3 1 | 0.7 5 | 1.7 5 | 0.6 3 | 1.3 1 | 0.5 | 4.5 | 6.0 6 | 3.1 9 | 2.8 8 |
| 5/8 | 5200 | 2.48 | 3 | 1.5 6 | 1.7 5 | 1.6 3 | 1.5 | 0.9 4 | 2.0 6 | 0.7 5 | 1.5 | 0.6 3 | 5.3 1 | 7.3 1 | 3.8 8 | 3.4 4 |
| 3/4 | 7200 | 3.88 | 3.5 | 1.7 5 | 2 | 1.8 8 | 1.8 8 | 1.1 3 | 2.5 3 | 0.8 8 | 1.7 5 | 0.7 5 | 6.0 6 | 8.3 1 | 4.3 1 | 4 |
| 7/8 | 10000 | 5.75 | 4 | 2.0 6 | 2.2 5 | 2.1 3 | 2.1 3 | 1.1 9 | 2.7 5 | 1 | 2.0 6 | 0.8 8 | 7 | 9.5 3 | 5 | 4.5 3 |