

# Jinbo Marine

Marine & Offshore Equipment Datasheet

PRODUCT DATASHEET

HOOK

## Eye Grab Hooks H323

Similar Name US Type Eye Grab Hooks H323 Eye Grab Hooks H323 Drop Forged Eye Grab Hooks H323 Galv Eye Grab Hooks H323 Lifting Eye Grab Hooks H323 Main Specification Forgin...

ISO9001 Supplier

Class Certificate

Export Supply



### Key Highlights

Category	Hook
Standard	EN
Material	45# Steel
Weight / Size	Similar Name US Type Eye Grab Hooks H323 Eye Grab Hooks H323 Drop Forged...
Certificate	ABS, LR, BV, DNVGL, NK, KR, IRS, RMRS, CCS

We can supply according to your requirement, drawings, class certificate needs, and delivery schedule.



Technical Specifications			
Category	Hook	Model / SKU	Eye-Grab-Hooks-H323
Standard	EN	Material	45# Steel
Weight / Size	Similar Name US Type Eye Grab Hooks H323 Eye Grab Hooks H323 Drop Forged Eye Grab Hooks H323 Galv Eye Grab Hooks H323 Lifting Eye Grab Hooks H323 Main Specification Forging Technology 45# Steel Galvanized, H.D.G, Paintng Size Table Size of Chain Working Load Limit DIMENSIONS(in) Weight (lbs) H-323 A-323 B E R 1/4" 2,600 3,600 1/2 11/32 1-31/32 0.28 5/16" 3,900 5,400 9/16 7/16 2002-1-4 0.45 3/8" 5,400 7,500 21/32 12 2002-9-16 0.79 1/2" 9,200 12,750 7/8 21/32 2003-3-8 1.75 5/8" 12,750 19,000 2001-1-16 25/32 4-3/32 3.25 3/4" 18,500 27,000 2001-3-8 15/16 5-5/32 5.94	Surface	Galvanized
Certificate	ABS, LR, BV, DNVGL, NK, KR, IRS, RMRS, CCS	Warranty	12 Months unless specified otherwise
Origin	China		

<b>CONTENTS</b>	■ Similar Name	■ Main Specification
	■ Size Table	

## Similar Name

US Type Eye Grab Hooks H323

Eye Grab Hooks H323

Drop Forged Eye Grab Hooks H323

Galv Eye Grab Hooks H323

Lifting Eye Grab Hooks H323

## Main Specification

Forging Technology

45# Steel

Galvanized, H.D.G, Paintng



## Size Table

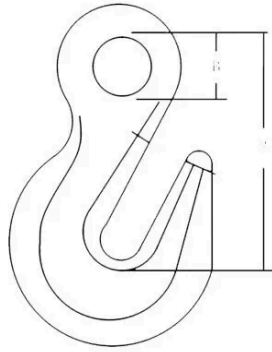

Size of Chain	Working Load Limit		DIMENSIONS(in)			Weight (lbs)
	H-323	A-323	B	E	R	
1/4"	2,600	3,600	1/2	11/32	1-31/32	0.28
5/16"	3,900	5,400	9/16	7/16	2002-1-4	0.45
3/8"	5,400	7,500	21/32	12	2002-9-16	0.79
1/2"	9,200	12,750	7/8	21/32	2003-3-8	1.75
5/8"	12,750	19,000	2001-1-16	25/32	4-3/32	3.25
3/4"	18,500	27,000	2001-3-8	15/16	5-5/32	5.94