

Jinbo Marine

Marine & Offshore Equipment Datasheet

PRODUCT DATASHEET

HIGH PRESSURE PUMP

HLF020 Series Hydraulic Jack

HLF Series Hydraulic Jack The automatic reset design of the piston is suitable for frequent use. Suitable for stretching single specification bolts with high accuracy. It can be equipped with manual pumps, pneumati...

ISO9001 Supplier

Class Certificate

Export Supply



Key Highlights

Category	High Pressure Pump
Standard	EN
Weight / Size	Model Size(mm) Maximum stretching (KN) Dimensions(mm) M Inch A C D E F H...
Certificate	ABS, LR, BV, DNVGL, NK, KR, IRS, RMRS, CCS

We can supply according to your requirement, drawings, class certificate needs, and delivery schedule.

Technical Specifications			
Category	High Pressure Pump	Model / SKU	HLF020-Series-Hydraulic-Jack
Standard	EN	Weight / Size	Model Size(mm) Maximum stretching (KN) Dimensions(mm) M Inch A C D E F HLF020 M20 51/64 200 42 52 65 19 20 94 HLF024 M24 1 290 49 60 78 22 24 102 HLF027 M27 1-1/8 380 55 67 86 25 27 108 HLF030 M30 1-1/8 460 61 74 97 27 30 106 HLF033 M33 1-1/4 570 66 81 107 29 33 114 HLF036 M36 1-3/8 670 71 90 117 32 36 118 HLF039 M39 1-1/2 800 77 96 127 34 39 125 HLF042 M42 1-5/8 920 83 102 137 37 42 134 HLF045 M45 1-3/4 1080 89 110 148 39 45 135 HLF048 M48 1-7/8 1220 94 116 158 42 48 140 HLF052 M52 2 1450 102 128 169 46 52 151 HLF056 M56 2-1/4 1680 106 135 176 49 56 158 HLF060 M60 2-3/8 2010 114 142 199 52 60 167 HLF064 M64 2-1/2 2210 120 151 211 55 64 172 HLF068 M68 2-3/4 2600 124 155 228 58 68 180 HLF072 M72 2-1/2 2880 130 168 238 62 72 186 HLF076 M80 3-1/4 3610 142 188 267 68 80 202 HLF080 M90 3-1/2 4650 160 210 300 77 90 220 HLF085 M100 4 5830 178 237 340 85 100 240
Certificate	ABS, LR, BV, DNVGL, NK, KR, IRS, RMRS, CCS	Warranty	12 Months unless specified otherwise
Origin	China		

CONTENTS

- HLF Series Hydraulic Jack

- Technical data:

HLF Series Hydraulic Jack

The automatic reset design of the piston is suitable for frequent use. Suitable for stretching single specification bolts with high accuracy. It can be equipped with manual pumps, pneumatic hydraulic pumps, and multiple stretchers can be used simultaneously. The standard working pressure is 150Mpa.



Technical data:

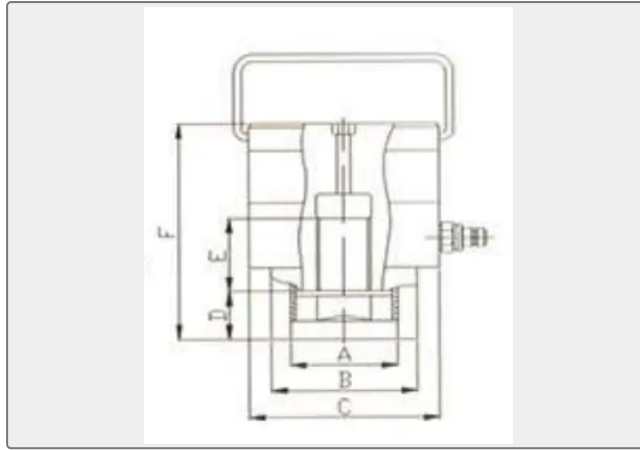

Model	Size(mm)		Maximum stretching (KN)	Dimensions(mm)					
	M	Inch		A	C	D	E	F	
HLF020	M20	51/64	200	42	52	65	19	20	94
HLF024	M24	1	290	49	60	78	22	24	102
HLF027	M27	1-1/8	380	55	67	86	25	27	108
HLF030	M30	1-1/8	460	61	74	97	27	30	106
HLF033	M33	1-1/4	570	66	81	107	29	33	114
HLF036	M36	1-3/8	670	71	90	117	32	36	118
HLF039	M39	1-1/2	800	77	96	127	34	39	125
HLF042	M42	1-5/8	920	83	102	137	37	42	134
HLF045	M45	1-3/4	1080	89	110	148	39	45	135
HLF048	M48	1-7/8	1220	94	116	158	42	48	140
HLF052	M52	2	1450	102	128	169	46	52	151
HLF056	M56	2-1/4	1680	106	135	176	49	56	158
HLF060	M60	2-3/8	2010	114	142	199	52	60	167
HLF064	M64	2-1/2	2210	120	151	211	55	64	172
HLF068	M68	2-3/4	2600	124	155	228	58	68	180
HLF072	M72	2-1/2	2880	130	168	238	62	72	186
HLF076	M80	3-1/4	3610	142	188	267	68	80	202
HLF080	M90	3-1/2	4650	160	210	300	77	90	220
HLF085	M100	4	5830	178	237	340	85	100	240

