

Jinbo Marine

Marine & Offshore Equipment Datasheet

PRODUCT DATASHEET

HIGH PRESSURE PUMP

HND080 Series Hydraulic Nut

HND080 Series Hydraulic Nut The HND series hydraulic nuts are mainly used for clamping tools. The working principle is to use oil pressure to push the piston to generate a clamping force, No external hydraul...

ISO9001 Supplier

Class Certificate

Export Supply



Key Highlights

Category	High Pressure Pump
Standard	EN
Certificate	ABS, LR, BV, DNVGL, NK, KR, IRS, RMRS, CCS

We can supply according to your requirement, drawings, class certificate needs, and delivery schedule.

Technical Specifications

Category	High Pressure Pump	Model / SKU	HND080-Series-Hydraulic-Nut
Standard	EN	Certificate	ABS, LR, BV, DNVGL, NK, KR, IRS, RMRS, CCS
Warranty	12 Months unless specified otherwise	Origin	China

CONTENTS

■ HND080 Series Hydraulic Nut

■ Technical data:

HND080 Series Hydraulic Nut

The HND series hydraulic nuts are mainly used for clamping tools. The working principle is to use oil pressure to push the piston to generate a clamping force,

No external hydraulic pump is required. Using specific wrenches, reliable, and easy to operate with axial and radial actuators

The pressure is evenly distributed on the pressure ring and will not deform under axial pressure. Use the minimum amount of grease to achieve the best effect. Usage range:



Metal shearing machine (uncoiling and slitting line) uses cutting tools to fasten fixtures; The fastening fixture used for Zhenglai forming and processing Use tools and fixtures to fasten other axes.

Technical data:

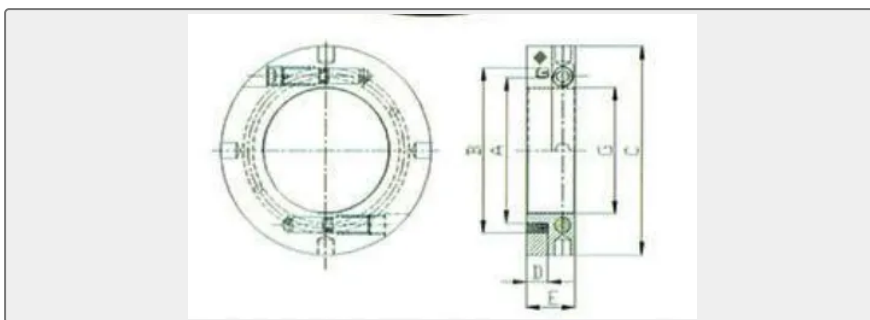

Model	Thread specification(mm)(mm)		Maximum tensile force (KN)	OD(m)	Height(m)	Pressure ring diameter(mm)	Distance of run (mm)
	M	in					
HND030	30	1-1/8	72.0	75	30	52/44	2
HND042	42	1-5/8	89.3	92	35	65/55	2
HND052	52	2	139.7	107	35	84/72	2
HND068	68	2-3/4	129.2	118	35	92/82	2
HND080	80	3-1/4	155.8	129	35	110/100	2
HND100	100	4	165-6	160	40	125/110	2
HND120	120	4-3/4	150.8	185	45	150/135	2
HND140	140	5-1/2	233.1	205	50	175/155	2
HND160	160	6-1/4	180.0	230	50	200/180	2
HND180	180	7	199.8	245	50	222/202	2