

**MARINE BOLLARD**

# JIS F-2804 Single Cruciform Bollard

Feature: 1.Long working life 2.High quality with competitive price. 3.Can be customized.

Dimension Table: Single Cruciform Bollard JIS F-2804 ...

- ISO9001 Supplier
- Class Certificate
- Export Supply



### Key Highlights

<b>Category</b>	Marine Bollard
<b>Standard</b>	JIS
<b>Material</b>	steel plate,steel pipe.
<b>Weight / Size</b>	Dimension Table:
<b>Certificate</b>	mill certificate.

We can supply according to your requirement, drawings, class certificate needs, and delivery schedule.

### Technical Specifications

<b>Category</b>	Marine Bollard	<b>Model / SKU</b>	JIS-F-2804-Single-Cruciform-Bollard
<b>Standard</b>	JIS	<b>Material</b>	steel plate,steel pipe.
<b>Weight / Size</b>	Dimension Table:	<b>Certificate</b>	mill certificate.
<b>Warranty</b>	12 Months unless specified otherwise	<b>Origin</b>	China

**CONTENTS**

- Feature:
- Core attributes:
- Dimension Table:

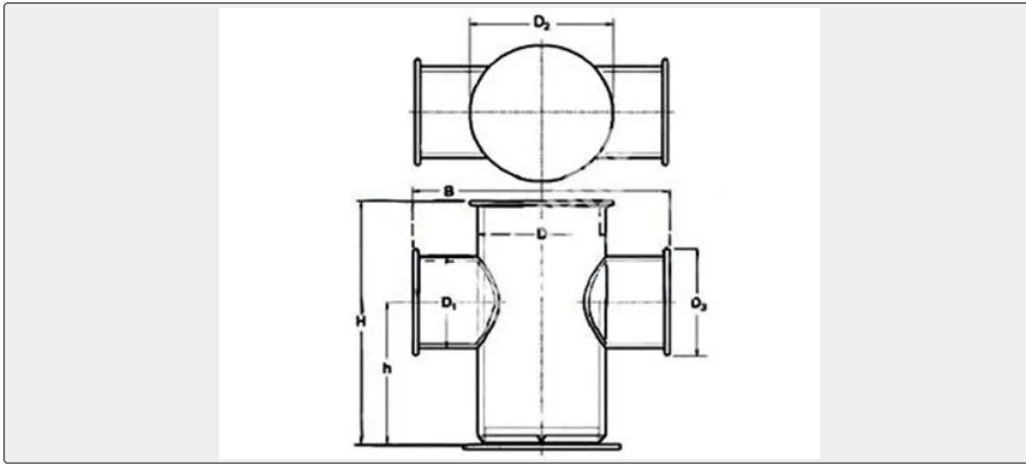

**Feature:**

- 1.Long working life
- 2.High quality with competitive price.
- 3.Can be customized.

**Dimension Table:**

Single Cruciform Bollard JIS F-2804										
Product No.	Nominal Dia.(mm)	Dimension(mm)								Wire Rope Dia.(mm)
		H	h	B	D	D1	D2	D3	Weight(kg)	
SCB-001	150	480	280	460	165	114	206	158	33	16
SCB-002	200	560	320	520	216	165	256	206	60	22
SCB-003	250	640	360	610	267	216	308	256	102	28
SCB-004	300	680	380	660	318	267	360	308	154	34
SCB-005	350	720	420	720	355	267	400	312	186	38

Nominal size of single **cruciform bollards**: 50mm,75mm 100mm

Nominal size of double cruciform bollards:50mm,75mm,100mm,125mm,150mm,175mm,200mm,250mm,300mm

Our bollards can be used for steel cables and ropes.

Nice shaped, good quality and with very low maintenance.

LR,BV,CCS Certificate could be provided

Material: Steel Q235 ( ASTM36, SS400); Steel Q345B ( ASTM572-50, SM490, 50B)

Operating Life:10~15 Years

Guarantee Periods: 2 Years

Certificate: CCS, BV, ABS, GL, NK, etc.

Epoxy paint is usually a preference of a customer.

This bollard is custom made to satisfy your special requirements.

We also customize bollard products for special requirements.



## Core attributes:

- A. High quality SG iron as standard
- B. Strong and durable designs
- C. Very low maintenance
- D. Large line angles possible
- E. Standard and custom anchors available
- F. Specification and Type
- G. Bollards are manufactured in a wide range of shapes, sizes and capabilities. In general, the type bollard should always well as the general size ( i.e. height, head size, base size, etc) and load capacity.

Every enquiry from you will receive our prompt attention. kindly welcome to contact me directly.