

# Jinbo Marine

Marine & Offshore Equipment Datasheet

PRODUCT DATASHEET

SHACKLE

## JIS Type Shackles

Similar Name JIS Type Dee Shackle JIS Type Free Forged Shackle JIS Type Straight Shackle  
Main Specification U type body and a lateral pin. Drop Forged Q23...

- ISO9001 Supplier
- Class Certificate
- Export Supply



Key Highlights	
Category	Shackle
Standard	JIS
Material	Q235
Weight / Size	Size Table Nominal Size B D L dl SWL m/m In m/m m/m m/m m/m Ton 4.8 3/16...
Certificate	ABS, LR, BV, DNVGL, NK, KR, IRS, RMRS, CCS

We can supply according to your requirement, drawings, class certificate needs, and delivery schedule.

Technical Specifications			
<b>Category</b>	Shackle	<b>Model / SKU</b>	JIS-Type-Shackles
<b>Standard</b>	JIS	<b>Material</b>	Q235
<b>Weight / Size</b>	Size Table Nominal Size B D L dl SWL m/m In m/m m/m m/m m/m Ton 4.8 3/16 10 10 18.5 5 0.09 6 1/4 12 11 25 6.5 0.15 8 5/16 14 15 31 8.5 0.25 9 3/8 18 17 36 10 0.4 12 1/2 24 23 46 13 0.6 16 5/8 30 32 59 17 0.8 19 3/4 36 37 74 20 1 22 7/8 43 43 86 23 1.5 25 1 47 50 95 27 2 28 1 1/8 55 56 110 30 2.5 32 1 1/4 64 64 130 34 3.2 38 1 1/2 76 76 145 40 4.2 44 1 3/4 80 90 160 47 6.5 50 2 0 100 185 53 8 65 2 1/2 110 130 240 68 15 75 3 120 150 300 78 20	<b>Certificate</b>	ABS, LR, BV, DNVGL, NK, KR, IRS, RMRS, CCS
<b>Warranty</b>	12 Months unless specified otherwise	<b>Origin</b>	China



**CONTENTS**

■ Similar Name

■ Main Specification

■ Size Table

**Similar Name**

JIS Type Dee Shackle

JIS Type Free Forged Shackle

JIS Type Straight Shackle

**Main Specification**

- U type body and a lateral pin.
- Drop Forged
- Q235I
- Used in lifting or fasten cargo or machinery purpose.

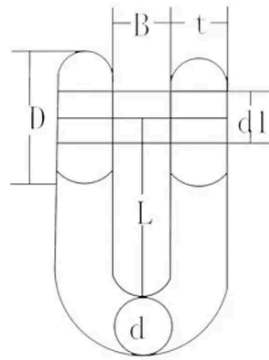
**Size Table**

Nominal Size	B	D	L	dl	SWL	
m/m	In	m/m	m/m	m/m	m/m	Ton
4.8	3/16	10	10	18.5	5	0.09
6	1/4	12	11	25	6.5	0.15
8	5/16	14	15	31	8.5	0.25
9	3/8	18	17	36	10	0.4
12	1/2	24	23	46	13	0.6
16	5/8	30	32	59	17	0.8
19	3/4	36	37	74	20	1
22	7/8	43	43	86	23	1.5
25	1	47	50	95	27	2
28	1 1/8	55	56	110	30	2.5

32	1 1/4	64	64	130	34	3.2
38	1 1/2	76	76	145	40	4.2
44	1 3/4	80	90	160	47	6.5
50	2	0	100	185	53	8
65	2 1/2	110	130	240	68	15
75	3	120	150	300	78	20