

LIFE-SAVING LIGHT

LP312A Ex-proof Perimeter Light

Product Description The LP3 series ex-proof perimeter lights are used to mark the boundaries of offshore helipads, mobile platforms and fixed platforms. They are suitable for explosive gas environments of ...

ISO9001 Supplier

Class Certificate

Export Supply



Key Highlights

Category	Life-Saving Light
Standard	ISO
Material	They are suitable for explosive gas environments of IIA, IIB, IIC and te...
Weight / Size	Electrical Operating voltage 24VDC Power consumption ≤5W Dimming mode...
Certificate	ABS, LR, BV, DNVGL, NK, KR, IRS, RMRS, CCS

We can supply according to your requirement, drawings, class certificate needs, and delivery schedule.

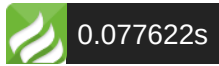

Technical Specifications

Category	Life-Saving Light	Model / SKU	LP312A-Ex-proof-Perimeter-Light
Standard	ISO	Material	<p>They are suitable for explosive gas environments of IIA, IIB, IIC and temperature groups T1-T6 in Zone 1 and Zone 2 locations, such as offshore oil platforms, oil tankers and other hazardous areas and helicopter pads on ships. Product Features Stainless steel 316 light housing, with corrosion and vibration resistant features, IP protection can be IP67, suitable for hazardous outdoor environment. Professional photometric design, use the high and low temperature resistant PC lens to make sure can be long term photometric qualified. Tempered glass light cover, operation temperature can be-50°C, with 4J shock resistance, hot and cold upheaval resistance and 5Mpastatic pressure qualified features. Lamp is using LED light source , design with professional heat simulation software to make sure the chips' temperature will lower than 85°C when operation to make sure the stable light illuminations. With Dimming function, can use the PWM or RS485(0-100)to be stepless dimming to avoid light dazzle when pilot approaching.</p>

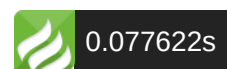

<p>Weight / Size</p> <p>Electrical Operating voltage 24VDC Power consumption ≤5W Dimming mode PWM 2-M20x1.5 (It needs to be used in conjunction with the appropriate explosion-proof connectors) Wiring EMC GD22-2015 L-L ±0.5kV GD22-2015 L-G ±1kV GD22-2015 contact discharge±8kV GD22-2015 air discharge± Mechanical Housing material SUS316 Cover material Tempered glass Weight 4.3kg Mounting Surface mount Operating temperature - 50°C ~ +60°C Storage temperature-50°C ~ +70°C perating humidity 10%~95%RH IP rate IEC60529 IP67 Salt spray rate ISO9227 NSS 1440h</p>	<p>Surface</p> <p>Electrical Operating voltage 24VDC Power consumption ≤5W Dimming mode PWM 2-M20x1.5 (It needs to be used in conjunction with the appropriate explosion-proof connectors) Wiring EMC GD22-2015 L-L ±0.5kV GD22-2015 L-G ±1kV GD22-2015 contact discharge±8kV GD22-2015 air discharge± Mechanical Housing material SUS316 Cover material Tempered glass Weight 4.3kg Mounting Surface mount Operating temperature - 50°C ~ +60°C Storage temperature-50°C ~ +70°C perating humidity 10%~95%RH IP rate IEC60529 IP67 Salt spray rate ISO9227 NSS 1440h</p>
<p>Certificate</p> <p>ABS, LR, BV, DNVGL, NK, KR, IRS, RMRS, CCS</p>	<p>Warranty</p> <p>12 Months unless specified otherwise</p>
<p>Origin</p> <p>China</p>	

<p>CONTENTS</p>	<ul style="list-style-type: none"> ■ Product Description ■ Electrical 	<ul style="list-style-type: none"> ■ Product Features ■ Mechanical
------------------------	---	--

Product Description

The LP3 series ex-proof perimeter lights are used to mark the boundaries of offshore helipads, mobile platforms and fixed platforms. They are suitable for explosive gas environments of IIA, IIB, IIC and temperature groups T1-T6 in Zone 1 and Zone 2 locations, such as offshore oil platforms, oil tankers and other hazardous areas and helicopter pads on ships.

Product Features

Stainless steel 316 light housing, with corrosion and vibration resistant features, IP protection can be IP67, suitable for hazardous outdoor environment.

Professional photometric design, use the high and low temperature resistant PC lens to make sure can be long term photometric qualified.

Tempered glass light cover, operation temperature can be-50°C, with 4J shock resistance, hot and cold upheaval resistance and 5Mpastatic pressure qualified features.

Lamp is using LED light source , design with professional heat simulation software to make sure the chips' temperature will lower than 85°C when operation to make sure the stable light illuminations.

With Dimming function, can use the PWM or RS485(0-100)to be stepless dimming to avoid light dazzle when pilot approaching.



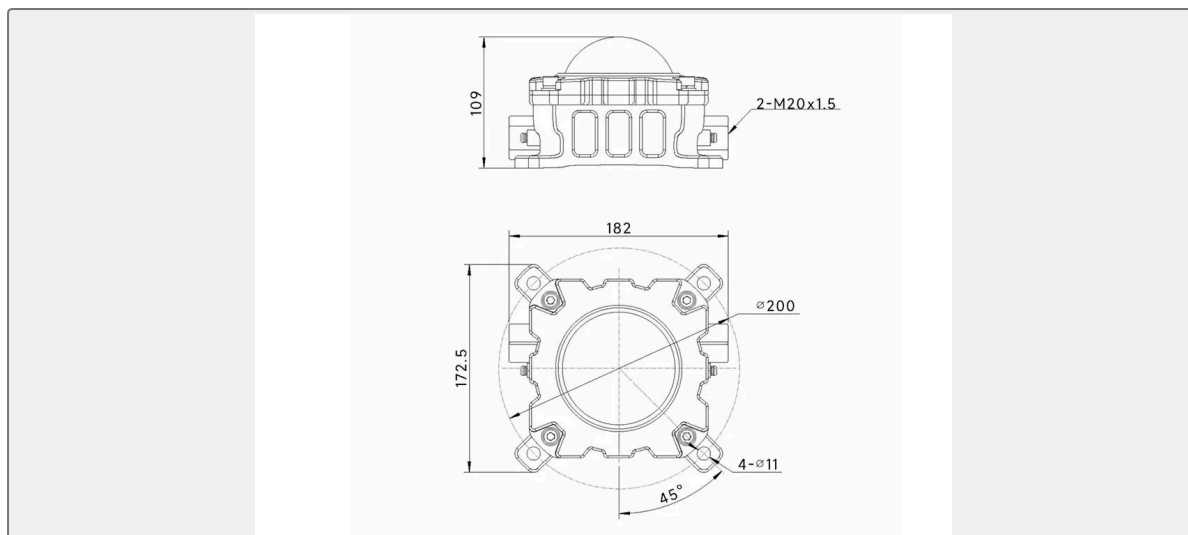

Electrical

Operating voltage 24VDC

Power consumption $\leq 5W$

Dimming mode PWM 2-M20x1.5 (It needs to be used in conjunction with the appropriate explosion-proof connectors)

Wiring EMC

GD22-2015 L-L $\pm 0.5kV$

GD22-2015 L-G $\pm 1kV$ GD22-2015

contact discharge $\pm 8kV$

GD22-2015 air discharge \pm

Mechanical

Housing material SUS316

Cover material Tempered glass

Weight 4.3kg

Mounting Surface mount

Operating temperature -

$50^{\circ}C \sim +60^{\circ}C$ Storage temperature $-50^{\circ}C \sim +70^{\circ}C$

perating humidity 10%~95%RH

IP rate IEC60529 IP67

Salt spray rate ISO9227 NSS 1440h