

## ELECTRICAL CONNECTORS

# Marine Brass Socket with Chain Switch CZKLS2-2

ISO9001 Supplier

Class Certificate

Export Supply

Marine Brass Socket with Chain Switch, CZKLS2-2



## Key Highlights

Category	Electrical Connectors
Material	Brass
Weight / Size	Marine Brass Socket with Chain Switch, CZKLS2-2 Technical Specification ...
Certificate	ABS, LR, BV, DNVGL, NK, KR, IRS, RMRS, CCS

We can supply according to your requirement, drawings, class certificate needs, and delivery schedule.

## Technical Specifications

Category	Electrical Connectors	Model / SKU	Marine-Brass-Socket-with-Chain-Switch-CZKLS2-2
Material	Brass	Weight / Size	Marine Brass Socket with Chain Switch, CZKLS2-2 Technical Specification Voltage 125V 250V 500V 500V Type CZKLS2-2D1 CZKLS2-2D2 CZKLS2-2D3 CZKLS32D4 Rating Current 10A 10A 10A Weight 2.14KGS 2.14KGS 2.14KGS 2.14KGS Protection Class IP56 Cable Outside Diameter Dia14-16
Certificate	ABS, LR, BV, DNVGL, NK, KR, IRS, RMRS, CCS	Warranty	12 Months unless specified otherwise
Origin	China		

## CONTENTS

- China Marine Brass Socket with Chain Switch CZKLS2-2:
- Technical Specification



0.048178s

## China Marine Brass Socket with Chain Switch CZKLS2-2:

Marine Brass Socket with Chain Switch, CZKLS2-2

### Technical Specification

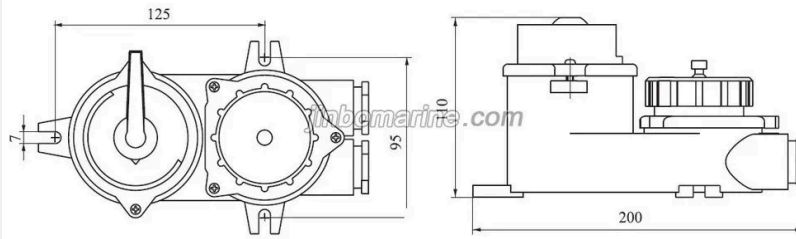

Voltage	125V	250V	500V	500V
Type	CZKLS2-2D1	CZKLS2-2D2	CZKLS2-2D3	CZKLS32D4
Rating Current	10A	10A	10A	10A
Weight	2.14KGS	2.14KGS	2.14KGS	2.14KGS
Portecting Class	IP56			
Cable Outside Diameter	Dia14-16			

