

TURNBUCKLE

# Swageless Jaw Terminal, SS304 OR SS316

ISO9001 Supplier

Class Certificate

Export Supply

SIZE D1 DIAM.WIRE (mm) A mm L1 mm L2 mm L3 mm KW mm KW1 mm WEIGHT / 100 pcs (KG) ...

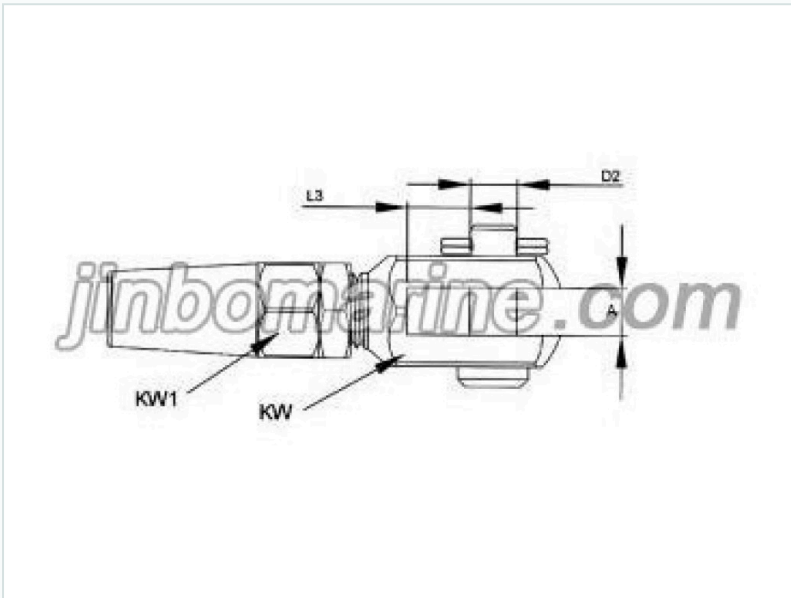

### Key Highlights

Category	Turnbuckle
Material	Stainless steel
Weight / Size	SIZE D1 DIAM.WIRE (mm) A mm L1 mm L2 mm L3 mm KW mm KW1 mm WEIGHT / 100 ...
Certificate	ABS, LR, BV, DNVGL, NK, KR, IRS, RMRS, CCS

We can supply according to your requirement, drawings, class certificate needs, and delivery schedule.

### Technical Specifications

Category	Turnbuckle	Model / SKU	SWAGELESS-JAW-TERMINAL-SS304-OR-SS316
Material	Stainless steel	Weight / Size	SIZE D1 DIAM.WIRE (mm) A mm L1 mm L2 mm L3 mm KW mm KW1 mm WEIGHT / 100 pcs (KG) Φ3 3 6.25 49 57 8 12 14 4 Φ4 4 7.9 60.5 71.4 8.3 14 19 8 Φ5 5 9.7 69 79 10 16 22 12 Φ6 6 11 81 93 12 19 27 21 Φ8 8 13 106 120 15 24 30 37.6 Φ10 10 16 119 137 13 32 27 -- Φ12 12 19 142 164 15 36 30 --
Certificate	ABS, LR, BV, DNVGL, NK, KR, IRS, RMRS, CCS	Warranty	12 Months unless specified otherwise
Origin	China		

## China Swageless Jaw Terminal, SS304 OR SS316:

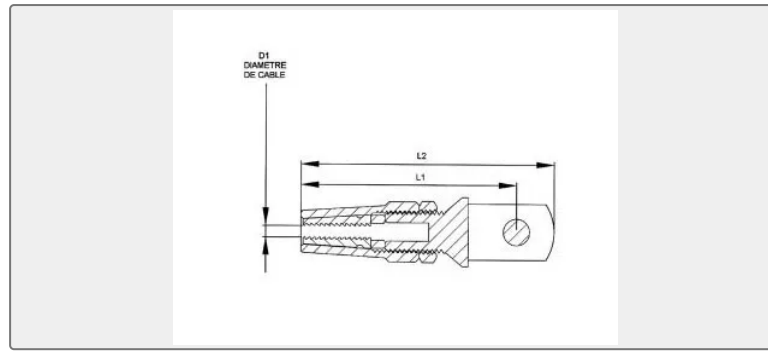

SIZE	D1 DIAM.WIRE (mm)	A mm	L1 mm	L2 mm	L3 mm	KW mm	KW1 mm	WEIGHT / 100 pcs (KG)
Φ3	3	6.25	49	57	8	12	14	4
Φ4	4	7.9	60.5	71.4	8.3	14	19	8
Φ5	5	9.7	69	79	10	16	22	12
Φ6	6	11	81	93	12	19	27	21
Φ8	8	13	106	120	15	24	30	37.6
Φ10	10	16	119	137	13	32	27	--
Φ12	12	19	142	164	15	36	30	--