

Jinbo Marine

Marine & Offshore Equipment Datasheet

PRODUCT DATASHEET

EYE BOLTS & NUTS

Screw Eye Bolts G275

Size Table Shank Diameter & Length (in.) Weight per 100 (1bs) Dimensions (in.) A B ...

- ISO9001 Supplier
- Class Certificate
- Export Supply



Key Highlights	
Category	Eye Bolts & Nuts
Standard	EN
Material	Q235,45#
Weight / Size	Size Table Shank Diameter & Length (in.) Weight per 100 (1bs) Dimensions ...
Certificate	ABS, LR, BV, DNVGL, NK, KR, IRS, RMRS, CCS
We can supply according to your requirement, drawings, class certificate needs, and delivery schedule.	

Technical Specifications			
Category	Eye Bolts & Nuts	Model / SKU	Screw-Eye-Bolts-G275
Standard	EN	Material	Q235,45#
Weight / Size	Size Table Shank Diameter & Length (in.) Weight per 100 (1bs) Dimensions (in.) A B C D E F G H J 1/4×2 4.25 0.25 1.5 2 2.5 2.94 0.5 0.88 0.19 0.47 5/16×2-1/4 6.25 0.31 1.69 2.25 2.94 3.5 0.63 1.13 0.25 0.56 3/8×2-1/2 18.75 0.38 1.88 2.5 3.28 3.97 0.75 1.38 0.31 0.66 1/2×3-1/4 37.5 0.5 2.44 3.25 4.25 5.12 1 1.75 0.38 0.91 5/8×4 68.75 0.63 3 4 5.31 6.44 1.25 2.25 0.5 1.12	Certificate	ABS, LR, BV, DNVGL, NK, KR, IRS, RMRS, CCS
Warranty	12 Months unless specified otherwise	Origin	China

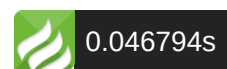

Size Table

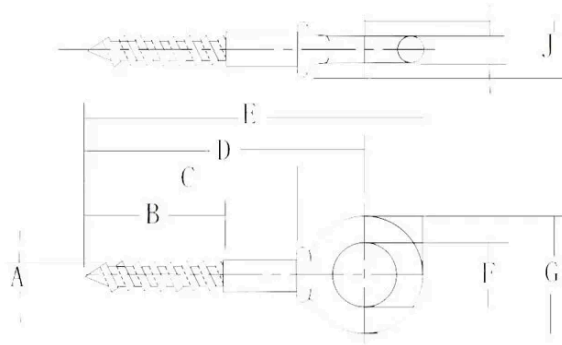

Shank Diameter & Length (in.)	Weight per 100 (lbs)	Dimensions (in.)								
		A	B	C	D	E	F	G	H	J
1/4×2	4.25	0.25	1.5	2	2.5	2.94	0.5	0.88	0.19	0.47
5/16×2-1/4	6.25	0.31	1.69	2.25	2.94	3.5	0.63	1.13	0.25	0.56
3/8×2-1/2	18.75	0.38	1.88	2.5	3.28	3.97	0.75	1.38	0.31	0.66
1/2×3-1/4	37.5	0.5	2.44	3.25	4.25	5.12	1	1.75	0.38	0.91
5/8×4	68.75	0.63	3	4	5.31	6.44	1.25	2.25	0.5	1.12