

# Jinbo Marine

Marine &amp; Offshore Equipment Datasheet

PRODUCT DATASHEET

## MARINE SILENCER

## Spark Trap Silencer with Sprinkler System

ISO9001 Supplier

Class Certificate

Export Supply

The Spark Trap Silencer with Sprinkler System is used to arrest the spark and muffle in the gas exhaust pipe line of main engine and auxiliary engine and boiler for the ships which carry crude oil, petroleum oil and chem...



### Key Highlights

Category	Marine Silencer
Standard	EN
Material	Carbon Steel
Weight / Size	1-Gas Exhaust Outlet 2-Water (Ash) Outlet DN20 3-Sight Hole 4-Joint for ...
Certificate	CCS, BV, ABS, GL, LR, DNV, NK,RINA, KR,IRS

We can supply according to your requirement, drawings, class certificate needs, and delivery schedule.

### Technical Specifications

Category	Marine Silencer	Model / SKU	Spark-Trap-Silencer-with-Sprinkler-System
Standard	EN	Material	Carbon Steel
Weight / Size	1-Gas Exhaust Outlet 2-Water (Ash) Outlet DN20 3-Sight Hole 4-Joint for Sprinkler 5-Support Main Size List(mm):	Certificate	CCS, BV, ABS, GL, LR, DNV, NK,RINA, KR,IRS
Warranty	12 Months unless specified otherwise	Origin	China

#### CONTENTS

- China Spark Trap Silencer with Sprinkler System:
- Main Parts:
- Main Size List(mm):

## China Spark Trap Silencer with Sprinkler System:

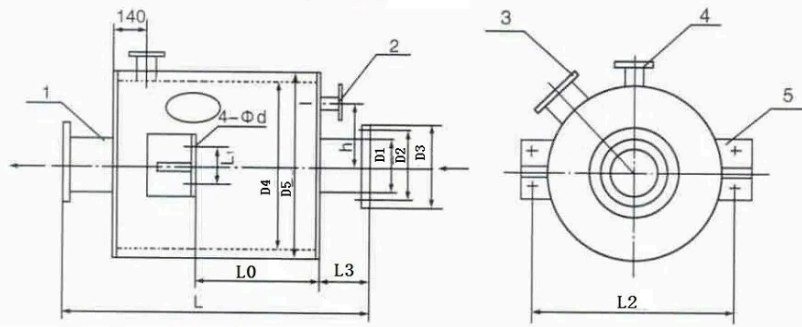

The Spark Trap Silencer with Sprinkler System is used to arrest the spark and muffle in the gas exhaust pipe line of main engine and auxiliary engine and boiler for the ships which carry crude oil, petroleum oil and chemical liquid.

### Main Parts:

- 1-Gas Exhaust Outlet
- 2-Water (Ash) Outlet DN20
- 3-Sight Hole
- 4-Joint for Sprinkler
- 5-Support

### Main Size List(mm):

Model No	DN	D1	D2	D3	D4	D5	L	L0	L1	L2	L3	d	h
DC454-65	65	76	123	155	200	280	900	—	—	—	160	15	44
DC454-80	80	89	138	170	220	300	1100	—	—	—	160	15	57
DC454-100	100	108	158	190	320	400	1210	—	—	—	180	15	80
DC454-125	150	159	208	240	390	470	1325	700	90	500	180	15	120
DC454-175	175	186	238	270	470	550	1480	800	90	580	180	15	130
DC454-200	200	216	264	295	510	590	1540	850	90	630	180	15	170
DC454-250	250	266	327	365	710	790	1600	900	110	850	200	15	200
DC454-300	300	316	386	430	760	840	1710	1100	110	900	200	21	250
DC454-350	350	366	436	480	840	920	1890	1300	110	980	200	21	290
DC454-400	400	416	486	530	960	1040	2100	1400	110	1100	200	21	300