

Jinbo Marine

Marine & Offshore Equipment Datasheet

PRODUCT DATASHEET

TURNBUCKLE

Turnbuckle Pipe (Jaw & Jaw) SS304 OR SS316

ISO9001 Supplier

Class Certificate

Export Supply

SIZE Φ mm A mm B mm C mm D mm SWL kgs BL kgs 5 5 10.5 ...

Key Highlights

Category	Turnbuckle
Material	Stainless steel
Weight / Size	SIZE Φ mm A mm B mm C mm D mm SWL kgs BL kgs 5 5 10.5 80 125 M5 189 750 ...
Certificate	ABS, LR, BV, DNVGL, NK, KR, IRS, RMRS, CCS

We can supply according to your requirement, drawings, class certificate needs, and delivery schedule.

Technical Specifications

Category	Turnbuckle	Model / SKU	TURNBUCKLE-PIPE-JAW-JAW-SS304-OR-SS316
Material	Stainless steel	Weight / Size	SIZE Φ mm A mm B mm C mm D mm SWL kgs BL kgs 5 5 10.5 80 125 M5 189 750 6 6 10.5 92 140 M6 350 1400 8 8 11.5 112 170 M8 550 2200 10 10 15.5 120 190 M10 865 3450 12 12 19.2 150 240 M12 1250 5000 14 14 16.2 170 190 M14 1600 6400 16 16 22.8 190 314 M16 2000 8000 20 20 27.3 220 452 M20 2625 10500
Certificate	ABS, LR, BV, DNVGL, NK, KR, IRS, RMRS, CCS	Warranty	12 Months unless specified otherwise
Origin	China		

China Turnbuckle Pipe (Jaw & Jaw) SS304 OR SS316:

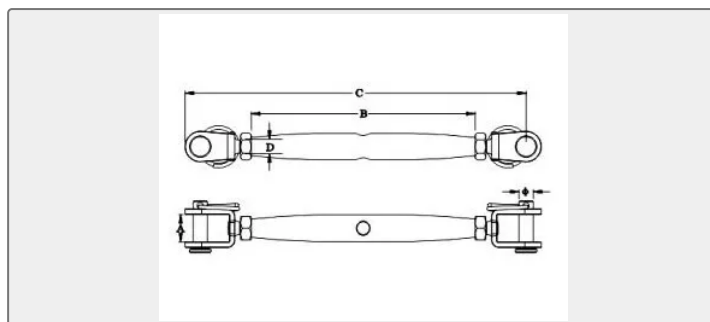

SIZE	Φ mm	A mm	B mm	C mm	D mm	SWL kgs	BL kgs
5	5	10.5	80	125	M5	189	750
6	6	10.5	92	140	M6	350	1400
8	8	11.5	112	170	M8	550	2200
10	10	15.5	120	190	M10	865	3450
12	12	19.2	150	240	M12	1250	5000
14	14	16.2	170	190	M14	1600	6400
16	16	22.8	190	314	M16	2000	8000
20	20	27.3	220	452	M20	2625	10500