

Jinbo Marine

Marine & Offshore Equipment Datasheet

PRODUCT DATASHEET

CEILING PANEL

Type D Ceiling Panel

Type D Ceiling Panel Model Thickness Fire class Core material T25D 25mm B-...

- ISO9001 Supplier
- Class Certificate
- Export Supply

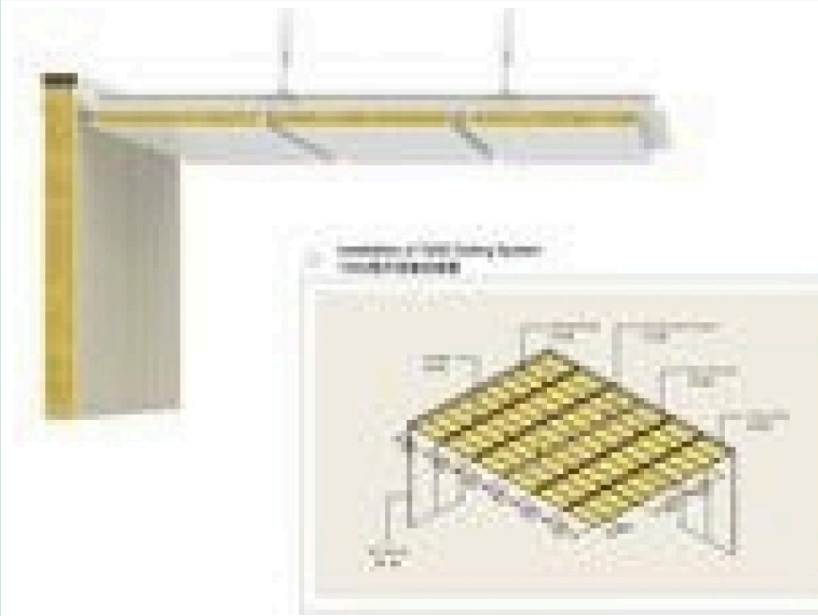
	<table border="1" style="width: 100%; border-collapse: collapse;"> <thead> <tr style="background-color: #1a3d4d; color: white;"> <th colspan="2">Key Highlights</th> </tr> </thead> <tbody> <tr> <td style="padding: 5px;">Category</td> <td style="padding: 5px;">Ceiling Panel</td> </tr> <tr> <td style="padding: 5px;">Standard</td> <td style="padding: 5px;">EN</td> </tr> <tr> <td style="padding: 5px;">Material</td> <td style="padding: 5px;">Rock Wool</td> </tr> <tr> <td style="padding: 5px;">Weight / Size</td> <td style="padding: 5px;">Type D Ceiling Panel Model Thickness Fire class Core material T25D 25mm ...</td> </tr> <tr> <td style="padding: 5px;">Certificate</td> <td style="padding: 5px;">ABS, LR, BV, GL, RINA, DNV, NK, KR, CCS</td> </tr> <tr style="background-color: #e6f2f8;"> <td colspan="2" style="padding: 10px;"> We can supply according to your requirement, drawings, class certificate needs, and delivery schedule. </td> </tr> </tbody> </table>	Key Highlights		Category	Ceiling Panel	Standard	EN	Material	Rock Wool	Weight / Size	Type D Ceiling Panel Model Thickness Fire class Core material T25D 25mm ...	Certificate	ABS, LR, BV, GL, RINA, DNV, NK, KR, CCS	We can supply according to your requirement, drawings, class certificate needs, and delivery schedule.	
Key Highlights															
Category	Ceiling Panel														
Standard	EN														
Material	Rock Wool														
Weight / Size	Type D Ceiling Panel Model Thickness Fire class Core material T25D 25mm ...														
Certificate	ABS, LR, BV, GL, RINA, DNV, NK, KR, CCS														
We can supply according to your requirement, drawings, class certificate needs, and delivery schedule.															

Technical Specifications			
Category	Ceiling Panel	Model / SKU	Type-D-Ceiling-Panel
Standard	EN	Material	Rock Wool
Weight / Size	<p>Type D Ceiling Panel Model Thickness Fire class Core material T25D 25mm B-0 rock wool T75DXY 75mm B-15 rock wool Main Specification Table 1 Type T25D Fire class B-0 Weight 7.9kg/m² Sound reduction -- Thermal transmittance 1.36Kcal/m²h°C Core material Rock wool 80kg/m³ Surface finish PVC film(150μ,low flame spread) or galvanized steel Dimension 25mm(t)×300mm(w)×length (max.3900mm) Tolerances Thickness0-1×Width0-1×Length±3 Table 2 Type T75DXY Fire class B-15 Weight 12.7kg/m² Sound reduction 0.85 Thermal transmittance 0.40Kcal/m²h°C Core material Rock wool 80/150kg/m³ Surface finish PVC film(150μ,low flame spread) or galvanized steel Dimension 75mm(t)×300mm(w)×length (max.3900mm) Tolerances Thickness0-1×Width0-1×Length±3</p>	Surface	galvanized
Certificate	ABS, LR, BV, GL, RINA, DNV, NK, KR, CCS	Warranty	12 Months unless specified otherwise
Origin	China		

CONTENTS

- Type D Ceiling Panel

- Main Specification

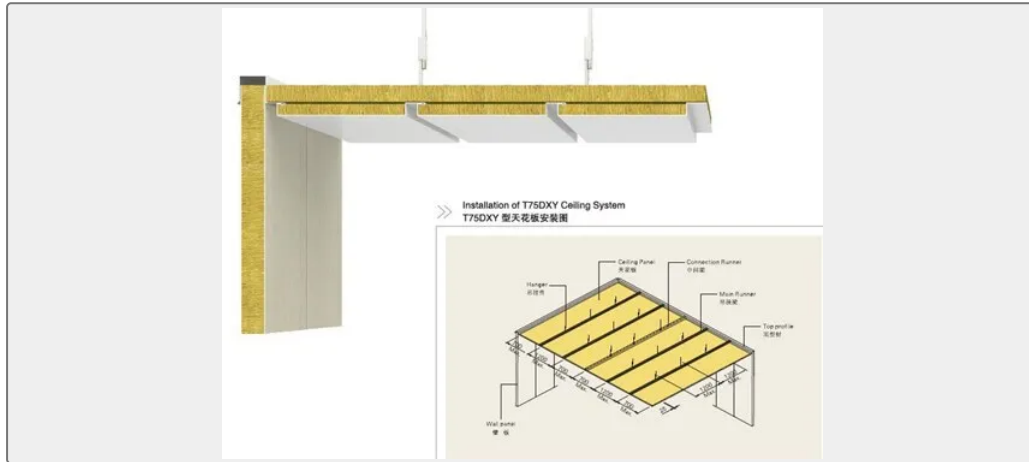
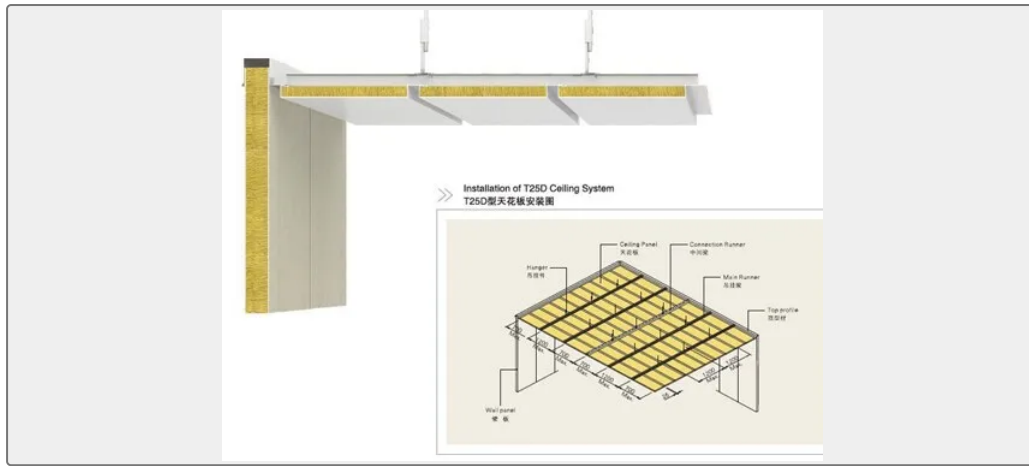

Type D Ceiling Panel

Model	Thickness	Fire class	Core material
T25D	25mm	B-0	rock wool
T75DXY	75mm	B-15	rock wool

Main Specification

Table 1

Type	T25D
Fire class	B-0
Weight	7.9kg/m ²
Sound reduction	--
Thermal transmittance	1.36Kcal/m ² h°C
Core material	Rock wool 80kg/m ³
Surface finish	PVC film(150μ, low flame spread) or galvanized steel
Dimension	25mm(t)×300mm(w)×length (max.3900mm)
Tolerances	Thickness0-1×Width0-1×Length±3

Table 2

Type	T75DXY
Fire class	B-15
Weight	12.7kg/m ²
Sound reduction	0.85
Thermal transmittance	0.40Kcal/m ² h°C
Core material	Rock wool 80/150kg/m ³
Surface finish	PVC film(150μ,low flame spread) or galvanized steel
Dimension	75mm(t)×300mm(w)×length (max.3900mm)
Tolerances	Thickness0-1×Width0-1×Length±3