

# Jinbo Marine

Marine &amp; Offshore Equipment Datasheet

PRODUCT DATASHEET

## SHACKLE

## US Type Bolt Anchor Shackle G2130

Similar Name US Type Screw Pin Anchor Shackle G-2130 US Type Bolt Anchor Shackle G-2130 US Type Bow Shackle G-2130 US Type Horseshoe-shaped Shackle G-2130 High Strength Shackle G-2130 ...

ISO9001 Supplier

Class Certificate

Export Supply



### Key Highlights

|               |   |
|---------------|---|
| Category      | Shackle   |
| Standard      | EN  |
| Material      | 45# Steel and 40Cr Steel  |
| Weight / Size | Size Table Nominal Size(in)<br>WLL (Tons) Dimension(in)<br>Weight(lbs) A B C D... |
| Certificate   | ABS, LR, BV, DNVGL, NK, KR,<br>IRS, RMRS, CCS                                     |

We can supply according to your requirement, drawings, class certificate needs, and delivery schedule.

| Technical Specifications |  |                    |  |
|--------------------------|--|--------------------|--|
| <b>Category</b>          | Shackle  | <b>Model / SKU</b> | US-Type-Bolt-Anchor-Shackle-G2130          |
| <b>Standard</b>          | EN   | <b>Material</b>    | 45# Steel and 40Cr Steel                   |
| <b>Weight / Size</b>     | Size Table Nominal Size(in) WLL (Tons) Dimension(in) Weight(lbs) A B C D E F H L N G-2130 3/16 1/3 0.38 0.25 0.88 0.19 0.6 0.56 1.47 0.98 0.19 0.06 1/4 1/2 0.47 0.31 1.13 0.25 0.78 0.61 1.84 1.28 0.25 0.11 5/16 3/4 0.53 0.38 1.22 0.31 0.84 0.75 2.09 1.47 0.31 0.22 3/8 1 0.66 0.44 1.44 0.38 1.03 0.91 2.49 1.78 0.38 0.33 7/16 1 1/2 0.75 0.5 1.69 0.44 1.16 1.06 2.91 2.03 0.44 0.49 1/2 2 0.81 0.64 1.88 0.5 1.31 1.19 3.28 2.31 0.5 0.79 5/8 3 1/4 1.06 0.77 2.38 0.63 1.69 1.5 4.19 2.94 0.69 1.68 3/4 4 3/4 1.25 0.89 2.81 0.75 2 1.81 4.97 3.5 0.81 2.72 7/8 6 1/2 1.44 1.02 3.31 0.88 2.28 2.09 5.83 4.03 0.97 3.95 1 8 1/2 1.69 1.15 3.75 1 2.69 2.38 6.56 4.69 1.06 5.66 1 1/8 9 1/2 1.81 1.25 4.25 1.13 2.91 2.69 7.47 5.16 1.25 8.27 1'1/4 12 2.03 1.4 4.69 1.29 3.25 3 8.25 5.75 1.38 11.71 1 3/8 13 1/2 2.25 1.53 5.25 1.42 3.63 3.31 9.16 6.38 1.5 15.83 1 1/2 17 2.38 1.66 5.75 1.53 3.88 3.63 10 6.88 1.62 19 1 3/4 25 2.88 2.04 7 1.84 5 4.19 12.34 8.8 2.25 33.91 2 35 3.25 2.3 7.75 2.08 5.75 4.81 13.68 10.15 2.4 52.25 2 1/2 55 4.13 2.8 10.5 2.71 7.25 5.69 17.9 12.75 3.13 98.25 3 85 5 3.3 13 3.12 7.88 6.5 21.5 14.62 3.62 154 '3 1/2 120 5.25 3.76 14.63 3.62 9 8 24.88 17.02 4.38 265 4 150 5.5 4.26 14.5 4 10 9 25.68 18 4.56 338 | <b>Certificate</b> | ABS, LR, BV, DNVGL, NK, KR, IRS, RMRS, CCS |
| <b>Warranty</b>          | 12 Months unless specified otherwise   | <b>Origin</b>      | China                                      |

|                 |                |                      |
|-----------------|----------------|----------------------|
| <b>CONTENTS</b> | ■ Similar Name | ■ Main Specification |
|                 | ■ Size Table   |                      |

## Similar Name

US Type Screw Pin Anchor Shackle G-2130

US Type Bolt Anchor Shackle G-2130

US Type Bow Shackle G-2130

US Type Horseshoe-shaped Shackle G-2130

High Strength Shackle G-2130

Alloy Steel Shackle G-2130

## Main Specification

- U type body and a lateral pin.
- Drop Forged
- 45# Steel and 40Cr Steel
- Used in lifting or fasten cargo or machinery purpose.

## Size Table

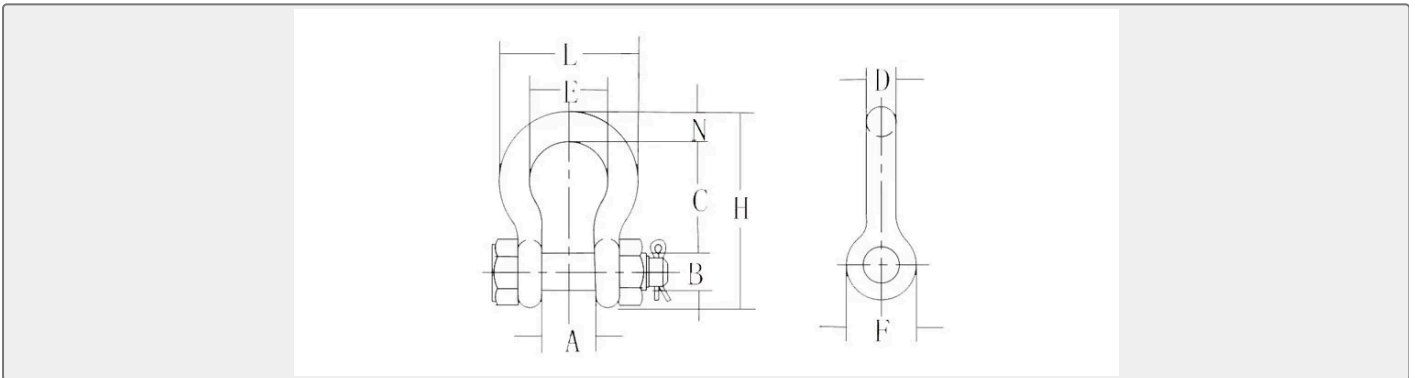

| Nominal Size(in) | WLL (Tons) | Dimension(in) |      |      |      |      |      |      |      |      |        | Weight(lbs ) |
|------------------|------------|---------------|------|------|------|------|------|------|------|------|--------|--------------|
|                  |            | A             | B    | C    | D    | E    | F    | H    | L    | N    | G-2130 |              |
| 3/16             | 1/3        | 0.38          | 0.25 | 0.88 | 0.19 | 0.6  | 0.56 | 1.47 | 0.98 | 0.19 | 0.06   |              |
| 1/4              | 1/2        | 0.47          | 0.31 | 1.13 | 0.25 | 0.78 | 0.61 | 1.84 | 1.28 | 0.25 | 0.11   |              |
| 5/16             | 3/4        | 0.53          | 0.38 | 1.22 | 0.31 | 0.84 | 0.75 | 2.09 | 1.47 | 0.31 | 0.22   |              |
| 3/8              | 1          | 0.66          | 0.44 | 1.44 | 0.38 | 1.03 | 0.91 | 2.49 | 1.78 | 0.38 | 0.33   |              |
| 7/16             | 1 1/2      | 0.75          | 0.5  | 1.69 | 0.44 | 1.16 | 1.06 | 2.91 | 2.03 | 0.44 | 0.49   |              |
| 1/2              | 2          | 0.81          | 0.64 | 1.88 | 0.5  | 1.31 | 1.19 | 3.28 | 2.31 | 0.5  | 0.79   |              |
| 5/8              | 3 1/4      | 1.06          | 0.77 | 2.38 | 0.63 | 1.69 | 1.5  | 4.19 | 2.94 | 0.69 | 1.68   |              |
| 3/4              | 4 3/4      | 1.25          | 0.89 | 2.81 | 0.75 | 2    | 1.81 | 4.97 | 3.5  | 0.81 | 2.72   |              |
| 7/8              | 6 1/2      | 1.44          | 1.02 | 3.31 | 0.88 | 2.28 | 2.09 | 5.83 | 4.03 | 0.97 | 3.95   |              |
| 1                | 8 1/2      | 1.69          | 1.15 | 3.75 | 1    | 2.69 | 2.38 | 6.56 | 4.69 | 1.06 | 5.66   |              |

|       |        |      |      |       |      |      |      |       |       |      |       |
|-------|--------|------|------|-------|------|------|------|-------|-------|------|-------|
| 1 1/8 | 9 1/2  | 1.81 | 1.25 | 4.25  | 1.13 | 2.91 | 2.69 | 7.47  | 5.16  | 1.25 | 8.27  |
| 1 1/4 | 12     | 2.03 | 1.4  | 4.69  | 1.29 | 3.25 | 3    | 8.25  | 5.75  | 1.38 | 11.71 |
| 1 3/8 | 13 1/2 | 2.25 | 1.53 | 5.25  | 1.42 | 3.63 | 3.31 | 9.16  | 6.38  | 1.5  | 15.83 |
| 1 1/2 | 17     | 2.38 | 1.66 | 5.75  | 1.53 | 3.88 | 3.63 | 10    | 6.88  | 1.62 | 19    |
| 1 3/4 | 25     | 2.88 | 2.04 | 7     | 1.84 | 5    | 4.19 | 12.34 | 8.8   | 2.25 | 33.91 |
| 2     | 35     | 3.25 | 2.3  | 7.75  | 2.08 | 5.75 | 4.81 | 13.68 | 10.15 | 2.4  | 52.25 |
| 2 1/2 | 55     | 4.13 | 2.8  | 10.5  | 2.71 | 7.25 | 5.69 | 17.9  | 12.75 | 3.13 | 98.25 |
| 3     | 85     | 5    | 3.3  | 13    | 3.12 | 7.88 | 6.5  | 21.5  | 14.62 | 3.62 | 154   |
| 3 1/2 | 120    | 5.25 | 3.76 | 14.63 | 3.62 | 9    | 8    | 24.88 | 17.02 | 4.38 | 265   |
| 4     | 150    | 5.5  | 4.26 | 14.5  | 4    | 10   | 9    | 25.68 | 18    | 4.56 | 338   |