

SHACKLE

US Type Screw Pin Anchor Shackle G213

ISO9001 Supplier

Class Certificate

Export Supply

Similar Name US Type Screw Pin Anchor Shackle G-213 US Type Bolt Anchor Shackle G-213 US Type Bow Shackle G-213 US Type Horseshoe-shaped Shackle G-213 High Strength Shackle G-213 Alloy...

	Key Highlights	
	Category	Shackle
	Standard	EN
	Material	45# Steel and 40Cr Steel
	Weight / Size	Size Table Nominal Size(in) WLL (Tons) Dimension(in) Weight(lbs) A B C D...
Certificate	ABS, LR, BV, DNVGL, NK, KR, IRS, RMRS, CCS	
<p>We can supply according to your requirement, drawings, class certificate needs, and delivery schedule.</p>		



Technical Specifications			
Category	Shackle	Model / SKU	US-Type-Screw-Pin-Anchor-Shackle-G213
Standard	EN	Material	45# Steel and 40Cr Steel
Weight / Size	Size Table Nominal Size(in) WLL (Tons) Dimension(in) Weight(lbs) A B C D E F G H N P G213/S213 1/4 1/2 0.47 0.31 1.13 0.25 0.78 0.61 1.28 1.84 1.34 0.25 0.13 5/16 3/4 0.53 0.38 1.22 0.31 0.84 0.75 1.47 2.09 1.59 0.31 0.18 3/8 1 0.66 0.44 1.44 0.38 1.03 0.91 1.78 2.49 1.86 0.38 0.29 7/16 1 1/2 0.75 0.5 1.69 0.44 1.16 1.06 2.03 2.91 2.13 0.44 0.38 1/2 2 0.81 0.63 1.88 0.5 1.31 1.19 2.31 3.28 2.38 0.5 0.71 5/8 3 1/4 1.06 0.75 2.38 0.63 1.69 1.5 2.94 4.19 2.91 0.69 1.5 3/4 4 3/4 1.25 0.88 2.81 0.75 2 1.81 3.5 4.97 3.44 0.81 2.32 7/8 6 1/2 1.44 1 3.31 0.88 2.28 2.09 4.03 5.83 3.81 0.97 3.49 1 8 1/2 1.69 1.13 3.75 1 2.69 2.38 4.69 6.56 4.53 1.06 5 1 1/8 9 1/2 1.81 1.25 4.25 1.13 2.91 2.69 5.16 7.47 5.13 1.25 6.97 1 1/4 12 2.03 1.38 4.69 1.29 3.25 3 5.75 8.25 5.5 1.38 9.75 1 3/8 13 1/2 2.25 1.5 5.25 1.42 3.63 3.31 6.38 9.16 6.13 1.5 13.25 1 1/2 17 2.38 1.63 5.75 1.54 3.88 3.63 6.88 10 6.5 1.62 17.25 1 3/4 25 2.88 2 7 1.84 5 4.19 8.86 12.34 7.75 2.25 29.46 2 35 3.25 2.25 7.75 2.08 5.75 4.81 9.97 13.68 8.75 2.4 45.75	Certificate	ABS, LR, BV, DNVGL, NK, KR, IRS, RMRS, CCS
Warranty	12 Months unless specified otherwise	Origin	China

CONTENTS	<ul style="list-style-type: none"> ■ Similar Name ■ Size Table 	<ul style="list-style-type: none"> ■ Main Specification
-----------------	--	--

Similar Name

US Type Screw Pin Anchor Shackle G-213

US Type Bolt Anchor Shackle G-213



US Type Bow Shackle G-213

US Type Horseshoe-shaped Shackle G-213

High Strength Shackle G-213

Alloy Steel Shackle G-213

Main Specification

- U type body and a lateral pin.
- Drop Forged
- 45# Steel and 40Cr Steel
- Used in lifting or fasten cargo or machinery purpose.

Size Table

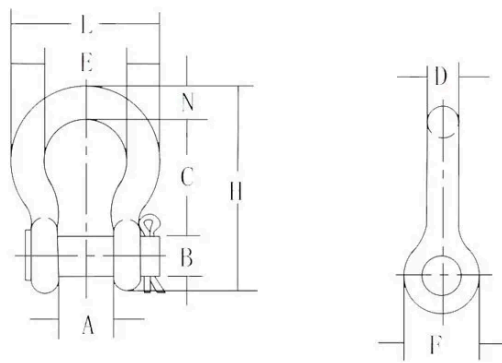

Nominal Size(in)	WLL (Tons)	Dimension(in)										Weight(lbs)	
		A	B	C	D	E	F	G	H	N	P		
1/4	1/2	0.47	0.31	1.13	0.25	0.78	0.61	1.28	1.84	1.34	0.25	G213/S213	0.13
5/16	3/4	0.53	0.38	1.22	0.31	0.84	0.75	1.47	2.09	1.59	0.31		0.18
3/8	1	0.66	0.44	1.44	0.38	1.03	0.91	1.78	2.49	1.86	0.38		0.29
7/16	1 1/2	0.75	0.5	1.69	0.44	1.16	1.06	2.03	2.91	2.13	0.44		0.38
1/2	2	0.81	0.63	1.88	0.5	1.31	1.19	2.31	3.28	2.38	0.5		0.71
5/8	3 1/4	1.06	0.75	2.38	0.63	1.69	1.5	2.94	4.19	2.91	0.69		1.5
3/4	4 3/4	1.25	0.88	2.81	0.75	2	1.81	3.5	4.97	3.44	0.81		2.32
7/8	6 1/2	1.44	1	3.31	0.88	2.28	2.09	4.03	5.83	3.81	0.97		3.49
1	8 1/2	1.69	1.13	3.75	1	2.69	2.38	4.69	6.56	4.53	1.06		5
1 1/8	9 1/2	1.81	1.25	4.25	1.13	2.91	2.69	5.16	7.47	5.13	1.25		6.97
1 1/4	12	2.03	1.38	4.69	1.29	3.25	3	5.75	8.25	5.5	1.38		9.75
1 3/8	13 1/2	2.25	1.5	5.25	1.42	3.63	3.31	6.38	9.16	6.13	1.5		13.25
1 1/2	17	2.38	1.63	5.75	1.54	3.88	3.63	6.88	10	6.5			0.045372s

1 3/4	25	2.88	2	7	1.84	5	4.19	8.86	12.34	7.75	2.25	29.46
2	35	3.25	2.25	7.75	2.08	5.75	4.81	9.97	13.68	8.75	2.4	45.75

