

# Jinbo Marine

Marine &amp; Offshore Equipment Datasheet

PRODUCT DATASHEET

## YACHT &amp; BOAT ACCESSORY

## Wide JAW Quicklink, SS304 or SS316, Steel Electric Galvanized

SIZE  $\Phi$ A mm L1 mm L2 mm F mm W.L.L LBS 3.5 3.5 47 17 10 ...

ISO9001 Supplier

Class Certificate

Export Supply



### Key Highlights

Category	Yacht & Boat Accessory
Material	Stainless steel
Weight / Size	SIZE $\Phi$ A mm L1 mm L2 mm F mm W.L.L LBS 3.5 3.5 47 17 10 175 5 5 62 23 14 ...
Certificate	ABS, LR, BV, DNVGL, NK, KR, IRS, RMRS, CCS

We can supply according to your requirement, drawings, class certificate needs, and delivery schedule.

### Technical Specifications

Category	Yacht & Boat Accessory	Model / SKU	WIDE-JAW-QUICKLINK-SS304-OR-SS316-STEEL-ELECTRIC-GALVANIZED
Material	Stainless steel	Weight / Size	SIZE $\Phi$ A mm L1 mm L2 mm F mm W.L.L LBS 3.5 3.5 47 17 10 175 5 5 62 23 14 650 6 6 72 26.5 16 875 8 8 90 33.5 18 1525 12 12 122 47.5 23 2500
Certificate	ABS, LR, BV, DNVGL, NK, KR, IRS, RMRS, CCS	Warranty	12 Months unless specified otherwise
Origin	China		

## China Wide JAW Quicklink, SS304 or SS316, Steel Electric Galvanized:

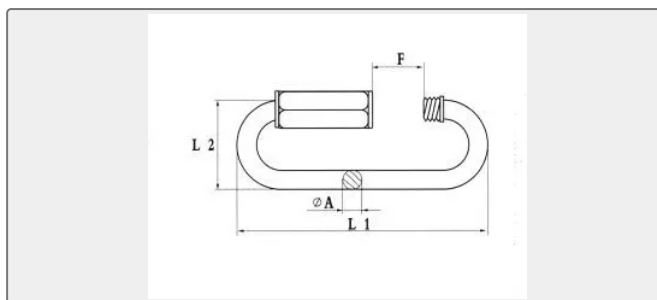

SIZE	ΦA mm	L1 mm	L2 mm	F mm	W.L.L LBS
3.5	3.5	47	17	10	175
5	5	62	23	14	650
6	6	72	26.5	16	875
8	8	90	33.5	18	1525
12	12	122	47.5	23	2500