

JIS F-2804 Single Cruciform Bollard



BV,CCS Certificate could be provided

Material: Steel Q235 (ASTM36, SS400); Steel Q345B (ASTM572-50, SM490, 50B)

Operating Life:10~15 Years

Guarantee Periods: 2 Years

Feature:

- 1.Long working life
- 2.Can be customized.
- 3.Nice shaped, good quality and with very low maintenance.

Drawing:

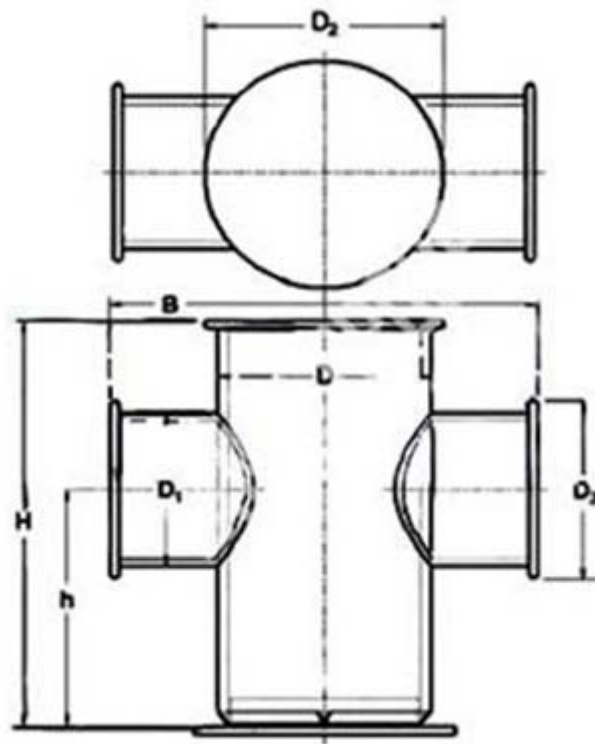

Dimension Table:

| Single Cruciform Bollard JIS F-2804 | | | | | | | | | | |
|-------------------------------------|------------------|---------------|-----|-----|-----|-----|-----|-----|------------|--------------------|
| Product No. | Nominal Dia.(mm) | Dimension(mm) | | | | | | | | Wire Rope Dia.(mm) |
| | | H | h | B | D | D1 | D2 | D3 | Weight(kg) | |
| SCB-001 | 150 | 480 | 280 | 460 | 165 | 114 | 206 | 158 | 33 | 16 |
| SCB-002 | 200 | 560 | 320 | 520 | 216 | 165 | 256 | 206 | 60 | 22 |
| SCB-003 | 250 | 640 | 360 | 610 | 267 | 216 | 308 | 256 | 102 | 28 |
| SCB-004 | 300 | 680 | 380 | 660 | 318 | 267 | 360 | 308 | 154 | 34 |
| SCB-005 | 350 | 720 | 420 | 720 | 355 | 267 | 400 | 312 | 186 | 38 |

Core attributes:

- A. High quality SG iron as standard
- B. Strong and durable designs
- C. Very low maintenance
- D. Large line angles possible
- E. Standard and custom anchors available
- F. Specification and Type
- G. Bollards are manufactured in a wide range of shapes, sizes and capabilities. In general, the type bollard should always well as the general size (i.e. height, head size, base size, etc) and load capacity.

Every enquiry from you will receive our prompt attention. kindly welcome to contact me directly.