

TØNSBERG MOORING LINK

Tønsberg Mooring Link - galvanised steel mooring link of compact design typically utilised as connection between wire rope and fibre tail. Available in three sizes 90 T, 120 T and 180 T. 300 T can be supplied on special request.

Link 90 T	Link 120 T	Link 180 T
Tail 56-68 mm	Tail 72-80 mm	Tail 88-112 mm
A = 285 mm	A = 324 mm	A = 350 mm
B = 115 mm	B = 142 mm	B = 184 mm
C = 136 mm	C = 150 mm	C = 160 mm
D = 65 mm	D = 75 mm	D = 85 mm
E = 75 mm	E = 90 mm	E = 120 mm
R = 22 mm	R = 28 mm	R = 30 mm
Breaking load: 90 Tonnes	Breaking load: 120 Tonnes	Breaking load: 180 Tonnes
Proof Load: 55 Tonnes	Proof Load: 70 Tonnes	Proof Load: 95 Tonnes
Weight: 11,2 Kg	Weight: 16,9 Kg	Weight: 25 Kg

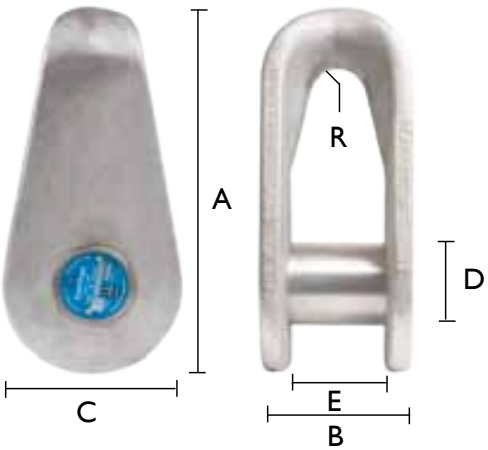

Each link is proof tested and certified by DNV.
DNV type approval certificate No. S-4718



Fibre rope around the bolt, wire rope around the body.

Tønsberg Mooring Link with roller		Tønsberg Mooring Link 300 T
120T	180T	A = 447 mm
Opening E = 90mm	120mm	B = 216 mm
Roller dia D = 82mm	97mm	C = 190 mm
		D = 110 mm
		E = 146 mm
		R = 36 mm
		Breaking load: 300 Tonnes
		Safe working Load: 100 Tonnes
		Weight: 52 Kg
		With works certificate

